

U.S. \$13.95/CANADA \$19.95

great american kitchens

VOLUME II

The Fine Art of Kitchen Design



53
Award-Winning
Rooms

U.S. \$13.95/CANADA \$19.95



cool ideas!

- lacquered cabinets
- stainless-steel backsplash
- hidden microwave
- double dishwashers

in the lime **light**

■ How do you turn a space of approximately 200 square feet into a welcoming, contemporary room? You devise a hardworking layout and select utilitarian materials carefully—then for surprise and excitement, you add color!

When this busy family with two teen-age daughters relocated from Great Britain to Ottawa, they purchased a new but traditional English-style home. The oak kitchen was hardly in keeping with the owners' love of color and playfulness; nor were they willing to forgo the contemporary look they had enjoyed abroad. Another mandate when they met with designer Friedemann Weinhardt of Design First Kitchen Interiors was for a space that would allow two cooks to work comfortably at the same time.

Storage, as in any compact space, was also an important issue. "We wanted an extremely functional kitchen with clean lines and a modern twist," comments the homeowner. "Basically we were looking to replace the existing kitchen with one with European styling."

The kitchen is without direct natural light, sitting between a breakfast area/family room with large windows on one side and the

This Euro-style kitchen blends sherbet-colored polyurethane lacquer cabinets by SieMatic, stainless-steel appliances and solid-surfacing countertops. Even the pendant lights conform to the cool color scheme. On the peninsula adjoining the breakfast room—whose large windows throw light into the kitchen—two dishwashers wear cabinet panels.

PHOTOGRAPHY: © TED YARWOOD, STYLING: BARBARA DIXON





formal dining room on the other. According to the designer, the homeowners wanted a color that “feels like summer, suggesting buds and plant stalks.” They used a paint swatch of Pratt & Lambert “Shy Green” to get the right color of matte lacquer polyurethane on the SieMatic cabinetry. The hint-of-mint color enhances the natural light borrowed from adjoining areas.

Two dishwashers and a Sub-Zero Model 700 TCI refrigerator-freezer, plus a 700 Series base refrigerator, are fronted with cabinet panels, achieving a clean look. On the cabinets, long, stainless-steel pulls, like those on the refrigerators, serve as the only ornamentation.

The team selected stainless steel for the ovens, cook-

top, hood, backsplash and sinks, citing its utility and appearance. “We chose the solid-surfacing countertop for its uniformity, clean lines and overall contemporary look,” explains the owner. “The very European color and stainless steel produce a unique blend,” notes the designer.

Recessed halogen lighting positioned over the center island and undercabinet spots provide plenty of artificial illumination. Pendant lights maintain the sleek, Euro look. According to the homeowner, “The ubiquitous microwave had to be accommodated inside an upper cupboard to the left of the range because Friedemann and I could not find anywhere aesthetically pleasing to place it.”

Every square foot of space is used optimally. As the



Above: The Sub-Zero 700 Series base refrigerator by the prep sink is designated for fresh produce. **Right:** On the pantry wall, pullouts flank the tall Sub-Zero Model 700 TCI refrigerator-freezer. **Far right:** Double ovens both open from the side. The island is close enough to use as a set-down area for hot pots.



“The very European color and stainless steel are a unique combination.”

owner says, "The island is great for both preparing and serving food." Both sides are utilized with refrigerated drawers, pullout containers for recyclables and narrow cupboards for glassware, vases and pitchers. On one wall, tall pullout pantry units access food staples and other ingredients.

"Of course, we would have preferred a larger space," she adds, "particularly with longer work surfaces, but the kitchen makes the most of the existing space, and there are no long walks for us. The floor plan allows a smooth transition from preparation to serving to cleanup."

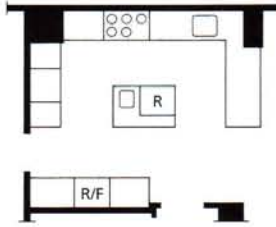

The peninsula that separates the kitchen from the breakfast area/family room houses a pair of dishwashers, which comes in handy when the family entertains. To mask the view of dirty dishes from guests seated in either the breakfast area or dining room, the adjacent stainless-steel sink and drain board are tucked in the corner—well out of sight.

In the breakfast room, the cabinet's color reappears in the chairs' upholstery. The oak strip floor that runs throughout the kitchen, breakfast room and family room contributes continuity and makes the kitchen proper appear larger.—*Barbara Dixon*

